



LOVE MY SKIN



FACIAL STEAMER

LMSFS1

Hello Beautiful, thank you for choosing our Facial Steamer. To make sure you get the best results, and use your device safely, it is important that you read and understand the instructions, warnings, precautions and safety information in this booklet. You should read these instructions before using your device for the first time, and we recommend you save the for future reference.

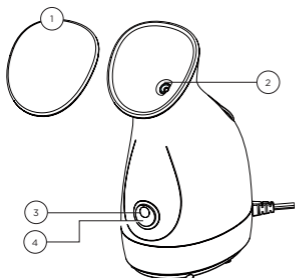

(Figure 1)

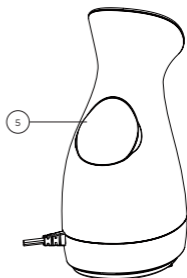

(Figure 2)

- 1. Dust Cover
- 2. Steam nozzle
- 3. Power Indicator

- 4. Switch
- 5. Water Tank

# THREE STEPS OF BEAUTY

---



## CLEANING CARE

It's very important to cleanse your face before steaming.



## STEAMING CARE

The facial steamer device can effectively open the pores to facilitate the removal of dirt ageing keratinocytes in the pores and promote the regeneration of collagen so that the skin is smooth we suggest steaming for 5 - 10 minutes, 2 - 3 times per week.



## NUTRITIONAL CARE

After steaming your face, the pores are open. Our facial steamer is perfect to use before a face mask and skincare routine session, as products are more conducive to skin nutrient absorption, which maximises the benefits of your favourite skin care products.

## ! CAUTIONS:

---

1. Warning: Use only distilled or purified water
2. The following types of water cannot be used: tap water, mineral water, geothermal water, acidic water, ionised alkaline water.
3. Do not mix any other substances in the water, such as lotion, aromatic oil etc, otherwise, it may cause burns, malfunctions, or shorten the life of the device.

## PREPARATIONS BEFORE USE

---

When using the appliance some water may remain around the water supply tank. This is residual water used for inspection in the factory and does not cause any sanitation problems.

1. Place the appliance on a flat, level surface during use.
2. Open the water supply tank and fill with water, and then close and tighten the cap. (figure 3)

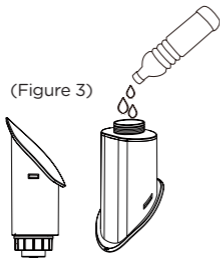

(Figure 4)

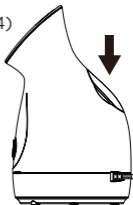

3. Push the main tank to the main unit until it is flat with main unit. When the water tank is installed in the main unit, it will supply water to the main unit immediately, the water in the tank will start to reduce.

## HOW TO USE

---

1. Plug the power cord into a household power outlet
2. Press the power switch to turn on the appliance, a red light on power switch will light up, once the appliance has been turned on, the steam will be released after 30 seconds. A small amount of steam may be emitted, this is a normal phenomenon not a malfunction.

### 3. Steam facial care.

- a. Keep your face at least 20 centimetres away from the nozzle. To ensure that the steam covers your entire face direct the steam to the top of your chin.
  - b. The steam will blow out after 30 seconds when the device has been opened.
  - c. When the remaining water is low, the way that the steam is admitted will change. This is not a malfunction. If there is no water in the water supply chamber please turn off the appliance and add water, then use again after allowing the appliance to cool down for at least 10 minutes.
  - d. Special note: if there is no water in the water tank, the appliance will automatically turn off, the temperature controller will cut off as well for protection, and immediately the water adding machine will not work, it will take about 2 minutes for the thermostat to automatically reset after the ambient temperature is reduced. This is normal and does not indicate any malfunction of the machine.
- ### 4. Turning off the appliance - slide the power switch downwards to turn off the appliance. After using it, take care of your skin by moisturising with lotion. If you do not moisturise there's a chance your skin will become dry as the water from the steamer will evaporate off the surface of your skin.

## AFTER USE

---

Be sure to discard water in the tank and the main unit every time you use the machine. Failure to do so could lead to water stains or unusual odours.



(Figure 5)



(Figure 6)

1. Leave the appliance alone to call for at least 10 minutes.
2. Remove the power plug from the electrical outlet. Remove the water supply tank and discard the water in the water supply tank and wipe away any water on the surface of the water supply tank.
3. Discard the water from the water outlet as shown on diagram. When disposing of water, hold the main unit so that your hands are not exposed to the hot water, otherwise this may result in burns.
4. Off to use, push the water supply tank in the main unit until it clicks.
5. Remove all the water in the water supply tank and the main unit were not using the device for extended periods of time (several weeks or more).

## CLEANING

1. fill the water supply tank with water and closed the water supply cap.
2. Attach the water supply tank to the main unit, shake the appliance horizontally three to four times, shake the appliance gently without tilting it.
3. Remove the water supply tank from the main unit and discard the water in the main unit. Return the appliance to a flat position and repeat this step above 2 to 3 times.

## SAFETY PRECAUTIONS

---

To ensure operation of this appliance please carefully read all of the safety precautions before use. Safety precautions are provided to help you with the correct and safe operation of the appliance so that you avoid injuries to yourself and others as well as damage to property.

Always follow these important safety precautions.

The safety precautions are defined as follows:

**⚠ WARNING:** this message indicates potentially hazardous actions and situations, which, if not avoided, could result in death or serious injury.

**CAUTION:** This message indicates potentially hazardous actions and situations, which if not avoided could result in personal injury or property damage.

### **WARNING:**

- Do not use this product near a full bath, sink, or any vessel containing water.
- Do not use this appliance by persons who are unable to feel. otherwise, it may result in burns or scalding.

- Immediately stop using if you experience any pain or abnormalities on your skin or throughout your body.

### **THE FOLLOWING PERSONS SHOULD NOT USE THIS APPLIANCE:**

1. Women who are pregnant or currently in a menstrual period (may cause skin problems due to hormone imbalance)
2. Persons with allergies, skin problems, such as dermatitis, severe sunburns.
3. Person with skin injuries, eczema, swelling, etc.
4. Person who are recovering after operation.
  - Do not touch any metal on the electrical plug when plugging in the plug, otherwise, it may cause accident.
  - Unplug after use, otherwise, it may cause personal injury or accident.
  - Turn the power off and unplug when not using, otherwise, it may result in fire or ignition.
  - Periodically clean to ensure dust does not accumulate on the plug.
  - Always ensure the appliance is operated on an electric power source matched to the rated voltage indicated on the appliance. Ensure that the plug is plugged in completely; otherwise, it may result in fire, electric shock, burns or scalding.

### **DO NOT USE THE APPLIANCE UNDER THE FOLLOWING CONDITIONS:**

1. When plug is loose in the power outlet.
2. Do not damage, modify, unreasonably bend, pull or twist the cord.
3. Do not place anything heavy on the cord and do not pinch the cord.
4. Do not let pins or dirt get attached to the end of the appliance plug.



- Do not plug or unplug the appliance plug into power outlets or use the appliance with wet hands.
- Do not use or store the appliance in the bathroom or in other rooms with high humidity. Humidity may cause the insulation to fail and may result in electric shocks or fire.
- Keep away from infants. Do not allow infants to use the appliance. Do not allow a child to lick the appliance plug. Doing so may cause injury, electric shock or burns.
- Do not use the appliance near flammable substances (alcohol, thinner, benzene, enamel remover, aerosol sprays, etc), otherwise, it may result in explosion or fire.
- Do not immerse the appliance. If the appliance sustains damage from being dropped or hit, please do not continue to use it.
- Do not insert objects in the steam outlet, and do not block the steam outlet, otherwise, it may result in explosion.
- Do not attempt to modify, disassemble, or repair the appliance.
- Contact the store where the appliance was purchased for repair; otherwise, it may cause injury due to fire or abnormal operation.

### CAUTION

- When disposing of the water after use, hold the appliance so that your hands are not exposed to the hot water.
- When disposing of the water after use, hold the appliance so that your hands are not exposed to the hot water.
- Use only distilled water or purified water. Failure to do so may result in equipment malfunction, or in serious cases, burns or scalding.
- Keep your hands away from the steam when operating the power switch.
- -Keep your face and hands at least 20cm from the module.
- Do not move the appliance during use or within 10 minutes after use. Doing so may cause hot water to spill out or a

large volume of steam to be emitted from the steam outlet.

- Use on a flat surface. Not for handheld use.
- Do not attach, remove or install water supply tank during use or within 10 minutes after use. Steam continues to be emitted after the power has been cut off. Stay away from the nozzle immediately after use.
- Except when cleaning, do not shake the main unit when it contains water. Please do not drain the water through the steam outlet otherwise it may cause hot water to spray out when the power is turned on, as water droplets collect in the steam outlet. This can cause burns or scalding.
- This appliance is not intended for use by persons (including children) with reduced physical, sensory or mental capabilities, or lack of experience and knowledge, unless they are being supervised or have been given instructions concerning use of the appliance by a person responsible for their safety.
- After use, the appliance should be cleaned to avoid the accumulation of grease and other residues.
- Properly dispose the package of the appliance, keep the package away from infants to prevent suffocation of infants from happening.

### **WARNING REGARDING YOUR SKIN**

- Initially, the appliance should only be used once a day, each time use cannot exceed 10 minutes. For normal skin, a maximum of 2 to 3 times a week, and for sensitive skin, one time per week is preferred.
- Stop using the appliance if skin troubles occur while using the steam.
- Basic skin care is required after using this steamer. Not performing skin care after using the steamer may cause the moisture in your skin to evaporate easily, drying out your skin.

# SPECIFICATIONS

|                     |  |           |       |
|---------------------|--|-----------|-------|
| Model               | LMSFS1                                     | Voltage   | 110V- |
| Power               | 280W                                       | Frequency |       |
| Capacity            | 70ml                                       | /         |       |
| Execution Standards | EN60335-1 EN60335-2-23 EN55014-1 EN55014-2 |           |       |

# ELECTRICAL SCHEMATICS

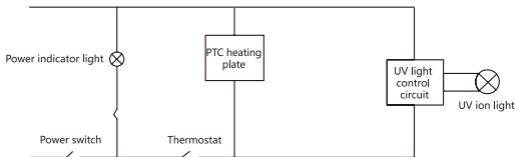

# FAQ

| Questions  | Reason                                | Solution                    |
|------------|---------------------------------------|-----------------------------|
| No heating | Switch is not turned on               | Turn on the switch          |
|            | Machine does not have connected power | Connect to power            |
|            | Household power fuse tripped          | Check power fuse and reset  |
| No steam   | Little or no water in the tank        | Promptly fill with water    |
|            | Contact failure with the water tank   | Remove to reinsert the tank |

# MANUFACTURE'S LIMITED WARRANTY

The manufacturer of facial steamer warrants the original purchaser of this product from an authorized reseller or distributor that this product will be free from defects in material and workmanship under normal use and service for one year after the date of purchase. Love My Skin's facial steamer will, at its option, repair or replace with a new or refurbished product. The manufacturer reserves the right before having any obligation under this limited warranty, to inspect the damaged product, the costs of shipping the damaged product for the inspection and warranty service shall be held solely by the purchaser.

The manufacturer's limited warranty is valid only in accordance with the following conditions:

The product is purchased directly from manufacturer or an authorized reseller. The warranty is not transferable, only the original purchaser is covered by this warranty.

This warranty is void when the product is used in a commercial or institutional use.

This warranty is void if the product has been subject to misuse, abuse, negligence, unauthorized modification or repair, or accident. Normal wear and tear are not covered by this warranty.

Purchaser must present acceptable proof of original receipt for the product. This warranty does not affect any other legal rights you may have by operation of law.



Model Reference



Manufacture Date



Complies with EU requirements



"Environment Protection" - Waste electrical products should not be disposed of with household waste. Please recycle where facilities exist. Check with your local

Authority or retailer for recycling advice.

Unit 3 Perrywood Business Park  
Honeycrook Lane, Redhill, RH1 5DZ UK

+44(0)1483 937967

[www.love-my-skin.co.uk](http://www.love-my-skin.co.uk)

Made in China