

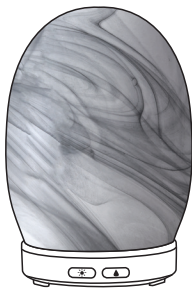

LOVE MY SKIN

Luxury Glass Diffuser



“Hello Beautiful”

Thank you for your purchase of the Love My Skin Luxury Glass Diffuser.
Please read the instructions and safety tips before use.

ATTACHMENT & SPECIFICATIONS

STANDARD PACKAGING CONTAINS:

1 x Love My Skin Diffuser

1 x USB Cable

1 x instruction manual

FEATURES

- Near silent operation
- Quick start
- Colour changing LED
- Fine mist
- USB-powered (plug adapter not included)

SPECIFICATIONS



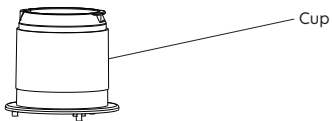
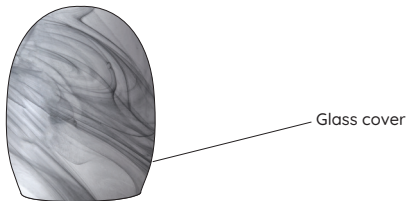

| | | | |
|---------------------|---|-----------------|---|
| Applicable area | 15m ² – 20m ² | Material | PP+ABS+PC+Silicon |
| Working temperature | 15-40°C | Dimension | Ø95x150mm |
| Input voltage | 100 volts-240 volts AC | Ultrasonic rate | 3.0MHz |
| Rated voltage | DC 5V | Accessories | <input type="checkbox"/> AC power adapter |
| Power consumption | Max 7.5 W | | <input type="checkbox"/> USB Cable <input type="checkbox"/> User Manual |
| Tank Capacity | 100ML | Quantity | X1 |
| Misting output | ≥15ml/hr | Weight | 144g-169g |
| Packaging size | Max: 285x205x178mm Min 247x172x170mm | Gross | Max: 1172.1g Min: 647.8g |

COMPONENTS

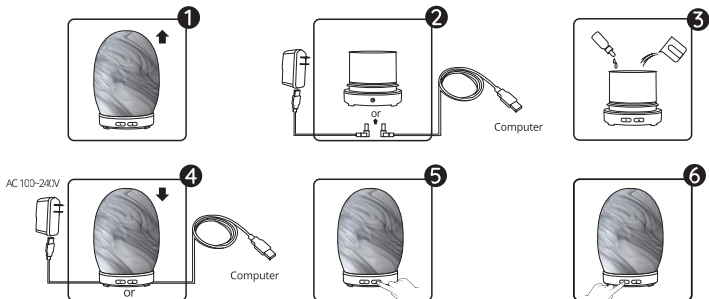

OPERATION



1. Place the diffuser correctly on a flat surface, remove the glass cover and the in-cover from the main body.
2. Fill water tank with water, no higher than the maximum water level line (150ml). Add 2-3 drops of essential oils into the water tank. Essential oil can be more or less according to personal preference.
3. Replace the in-cover and the glass cover to the original position of the main body. Plug adapter into USB slot of computer or Plug the AC adapter into the power socket.
4. Press  button to turn on the device and set as follows:
 - Press  button first time to turn on and start mist continuously
 - Press  button second time to turn off and stop mist
 - Press  button third time to turn off and stop mist
5. Press  button to turn on the LED illumination and set LED mode:
 - Diffuser comes with different LED lights to provide ambience that suits you.
6. When the diffuser detects water is below the minimum threshold, the device will automatically enter standby mode. To reactivate repeat steps 1-6

CLEANING & MAINTAINANCE

1. Unplug unit and pour out remaining water.
2. Use soft cloth with water to clean the main body and outer shell lightly.
3. After cleaning place in ventilated area to dry.
4. Disinfect with cotton swab dipped in alcohol and clean the dirt of the ultrasonic plate gently (picture A).
5. Replace the cover of the aroma diffuser (picture B).
6. Store in cool dry place.

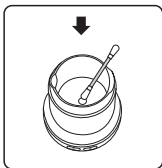

Picture A

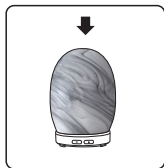

Picture B

NOTE:

1. Do not use acid or alkaline or other strong cleaning agents on unit. May cause damage or discolouration.
2. Change water daily. Do not use mineral water or water temperature above 15-40°C in unit.

WARNINGS & NOTICE

WARNINGS

1. Keep the diffuser out of reach of children.
2. Do not move when it is filled with water.
3. Do not fill water in use.
4. Do not exceed the maximum water level line.
5. Place unit on stable, level surface. Do not block steam outlet.
6. Unplug power supply during maintenance. Do not use if cord is damaged. Do not pull forcefully on cord and keep clear of pathways.
7. Clean the water tank weekly.
8. When not in use, remove water from tank.
9. This appliance is not intended for the use of children. Anyone planning to use this product must read the instructions thoroughly before use.
10. Before adding water and cleaning should first disconnect the power.

NOTICE:

1. The product is subject to change without prior notice.
2. Pictures for reference only.
3. Patented products, rights reserved.

TROUBLESHOOTING & SUPPORT

| Problem | Cause | Solution |
|---|---|---|
| Product stops working | Water below minimum threshold | Refill as per operational instructions 1-6 |
| | Power cables disconnected or damaged | <p>Check connection to the diffuser</p> <p>Check connection to the USB plug adapter</p> <p>Check there is no damage to the cable – replace if necessary (contact customer services)</p> |
| Water is over the max fill line | Too much water has been added | Remove excess water to below the max line |
| Issue of water smell when product is not in use | The diffuser has not been cleaned regularly | Clean the diffuser as per instructions |
| Little or no mist is being produced | The diffuser has not been cleaned regularly | Clean the diffuser as per instructions |
| The glass cover and inner cover do not fit properly | The covers have been incorrectly installed | Remove both covers and reinstall taking care to place them in the correct position |
| Water is leaking from the diffuser | Covers could be misaligned or tank overflow | Remove then replace both covers ensuring they are not misaligned. |
| | | If tank is overfilled then disconnect from power and remove some of the water. |

WARRANTY & SUPPORT

This diffuser comes with a UK limited 1 year warranty. For our full terms and conditions and to register your warranty please visit www.love-my-skin.co.uk

For questions on this diffuser please contact us on:

hello@love-my-skin.co.uk

Love My Skin / Kinetik Medical Devices Ltd

Medicity D6,

Thane Road

Nottingham

NG906BH, UK

+44 115 7840090



Symbol for "Manufacture Date".



Symbol for "Fragile; handle with care".



Symbol for "Environment Protection" – Waste electrical products should not be disposed of with household waste. Please recycle where facilities exist. Check with your local Authority or retailer for recycling advice.



Symbol for "Complies with EU requirements".
Fragile; handle with care



Model Reference.

LMSD2 UK IB 20180815